

TECHNICAL SPECIFICATIONS

User Interface

Although the TC Icon's full color touch screen is an integral part of the System 6000 user interface, Computer Keyboard, mouse and an external VGA screen output are also featured to really adapt to your set-up and working style. PC and Mac Editor will also be available in the very near future.

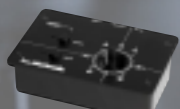

TC Electronic cascadable external SP-1 joystick.

Networking facilities

A 7.5 meter TC Electronic cable from the TC Icon to its CPU 6000 and a X-coupled Ethernet cable from the CPU 6000 to the Mainframe are both provided. Using the System 6000 Windows NT based Networking facilities, you can connect a number of mainframes in the machine room and have a number of TC Icons in different locations or have one TC Icon to control a number of Mainframes. Handling System 6000 project data over a Windows NT based network makes a tremendous difference to existing Windows NT users.



LAN Ethernet to Mainframe
Mouse Keyboard
VGA output
TC Electronic cable to TC Icon 7.5m (Provided)
USB

The Power Supply automatically accepts and adjusts itself to the voltage supplied between 100-240V, 50/60Hz.

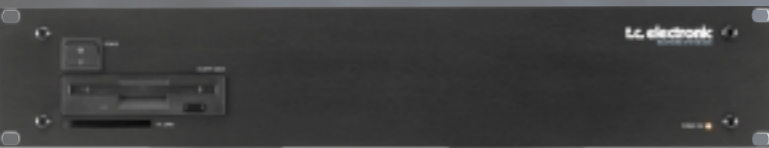

PCMCIA Slot Floppy Drive



TC Icon and Remote CPU 6000

Display Type:	6.5" TFT active matrix color LCD display, 640 x 480 pixels resolution. High luminance (500 cd/m2, typ.)
Touch Screen:	Resistive, 20 gram activation force
Faders:	Six (6), 90mm motorized with touch sensitivity
Connection:	36-pin MDR connection for Remote CPU 6000
EMC Complies with:	EN 55103-1 and EN 55103-2, FCC part 15 class B, CISPR 22 class B
Safety Certified to:	IEC 60065, EN 60065, UL 6500 and CSA E65
Environment	
Operating Temperature:	32° F to 122° F (0° C to 50° C)
Storage Temperature:	-22° F to 167° F (-30° C to 70° C)
Humidity:	Max. 90 % non-condensing
General	
Finish:	Black anodized aluminum Stand plate in brushed stainless steel
Dimensions:	D: 279mm W: 198mm H/Front: 33mm H/Back: 100mm
Weight:	5.56 lb (2.51 kg)
Warranty	1 year
Parts and Labor:	
Remote CPU 6000	
CPU:	Embedded Cyrix GXM-200 processor
System Disc:	32MB CompactFlash Card
System Memory:	32MB SODIMM Ram
Operating System:	Windows NT embedded version 1.0
Connections:	10/100 Mbits/s, Base-T, IEEE 802.3 p10 protocol compatible. RJ-45 connector
Ethernet Interface:	
USB Interface:	Two Universal Serial Bus ports, USB 1.0 compliant
Keyboard/Mouse:	Mini-DIN connector supports standard PC/AT keyboard and a PS/2 mouse.
Remote:	36-pin connection for TC Icon
EMC Complies with:	EN 55103-1 and EN 55103-2, FCC part 15 class B, CISPR 22 class B
Safety Certified to:	IEC 60065, EN 60065, UL 6500 and CSA E65
Environment	
Operating Temperature:	32° F to 122° F (0° C to 50° C)
Storage Temperature:	-22° F to 167° F (-30° C to 70° C)
Humidity:	Max. 90 % non-condensing
General	
Finish:	Black anodized aluminum face plate Painted and plated steel chassis
Dimensions:	1.75" x 1.9" x 8.2" inches (4.83 x 4.4 x 95 mm)
Weight:	4.7 lb. (2.13 kg)
Mains Voltage:	100 to 240 VAC, 50 to 60 Hz (auto-select)
Power Consumption:	50 watts
Backup Battery Life:	>10 years
Warranty	1 year
Parts and Labor:	

All trademarks are the properties of their respective companies and/or organizations. All rights reserved.

AES/EBU Eight channel Sync In word clock The Power Supply automatically accepts and adjusts itself to the voltage supplied between 100-240V, 50/60Hz.

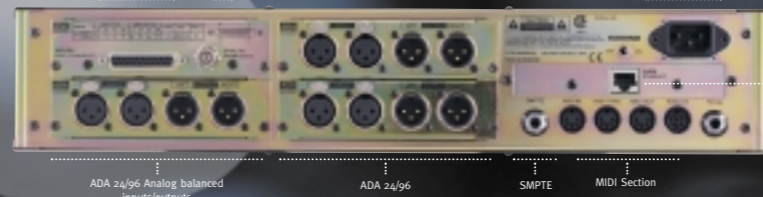

ADA 24/96 Analog balanced Inputs/Outputs
ADA 24/96
SMPTE
MIDI Section
LAN Ethernet
ADA 24/96 Analog I/O

Mainframe

Digital Inputs and Outputs

Connectors: D-Sub, 25 poles (8 channels AES/EBU in/out)
Formats: AES/EBU (24 bit)
Word Clock Input: BNC, 75 Ohm or HI-Z, 0.6 to 10 Vpp
Internal Sample Rate: 96 kHz, 88.2 kHz, 48.0 kHz, 44.1 kHz +/- 30 ppm
Internal Clock Precision: +/- 3 dB @ 50 Hz
Jitter/Rejection at External Sample Rates: 30 to 34 kHz, 42.5 to 45.5 kHz, 46.5 to 48.5 kHz, 85 to 91 kHz and 93 to 97 kHz
Rejection Filter (4th order): < -3 dB @ 50 Hz
< -45 dB @ 500 Hz
< -100 dB @ 1.4 kHz
< 1 dB @ 2 Hz
Rejection Filter Peak (jitter gain): < 1 ms peak, BW: 700 Hz to 100 kHz
Intrinsic Interface Jitter: < 3 % of sample period
Digital Output Phase: +/- 27 % / 77 % of sample period
Input variation before Sample Slip: HPF/PDF dither 8-24 bit, mono, stereo, inverted
Output Dither: 0.15 ms + 0.21 ms per engine @ 48 kHz, 0.07 ms + 0.1 ms per engine @ 96 kHz
Processing Delay: DC to 23.9 kHz + 0.01 dB @ 48 kHz, DC to 47.9 kHz + 0.01 dB @ 96 kHz

Frequency Response DIO:

PC Card, 68 pin type 1 cards
PCMCIA 2.0, JEIDA 4.0
Supports up to 2 MB SRAM

PCMCIA Interface

Connector: PC Card, 68 pin type 1 cards
Standards: PCMCIA 2.0, JEIDA 4.0
Card Format: Supports up to 2 MB SRAM

Floppydrive:

DOS compatible, 3 1/2", 1.44 Mb

Control Interface

MIDI: In/Out/Thru: 5 Pin DIN
GPU, Pedal, Fader: phone jack, 0 ohm to 50 kohm
Remote: Custom MIDI In & Out
SMPTE: Input for CueList Management
Ethernet: 10/100 Mbits/s, Base-T

EMC Complies with:

EN 55103-1 and EN 55103-2, FCC part 15 class B, CISPR 22 class B

Safety Certified to:

IEC 60065, EN 60065, UL 6500 and CSA E65

Environment

Operating Temperature: 32° F to 122° F (0° C to 50° C)
Storage Temperature: -22° F to 167° F (-30° C to 70° C)
Humidity: Max. 90 % non-condensing

General

Finish: Black anodized aluminum face plate
Painted and plated steel chassis

Dimensions:

3 1/2 x 1.9 x 12 inches
19 lbs. (8.6 kg)

Mains Voltage:

100 to 240 VAC, 50 to 60 Hz (auto-select)

Power Consumption:

45 watts

Backup Battery Life:

>10 years

Warranty

1 year

ADA 24/96 Analog I/O

Analog Input

Connectors: XLR balanced (pin 2+, pin 3-)
Impedance: 10/3 kohm (Balanced/unbalanced):

Selectable Full Scale Input level: 6, 12, 18, 24, 30 dBu

Dynamic Range (A-In: 12, 18, 24, 30 dBu): > 113 dB (unweighted), BW: 20-20kHz

THD+N: < -105 dB @ 1 kHz, -3 dBFS

Frequency Response, (*with linear filter):

Output Sample Rate: @32 kHz @44.1 kHz @48 kHz @96 kHz

2 Hz - 14.8 kHz 1.2 Hz - 19.9 kHz 1.2 Hz - 20.3 kHz 1.2 Hz - 44.4 kHz

+0/-0.1 dB: 0.2 Hz - 15.6 kHz 0.2 Hz - 20.6 kHz 0.2 Hz - 21.2 kHz 0.2 Hz - 46.8 kHz

+0/-3 dB: < -120 dB, 20 Hz to 20 kHz

Crosstalk: < -120 dB, 20 Hz to 20 kHz

CMRR (A-In: 24 dBu, Rs: 2 x 20 ohm): > 80 dB @ 50/60 Hz @ 190 dB @ 1 kHz

A to D Conversion: 24 bit (Dual bit delta sigma sampling at 4.1/5.6/6.1/6.1 MHz)

Analog Output

Connectors: XLR balanced (pin 2+, pin 3-)
Impedance: 40/20 ohm (Balanced/unbalanced)

Impedance Balance: > 60 dB @ 20-20kHz

Signal Balance: > 40 dB @ 20-20kHz

Selectable Full Scale Output level: 6/0, 12/6, 18/12, 24/18 dBu (Balanced/unbalanced)

Dynamic Range (A-Out: 18, 24 dBu): > 113 dB (unweighted), BW: 20-20kHz

THD+N: < -95 dB @ 1 kHz, -3 dBFS

Frequency Response, (*with linear filter):

Input Sample Rate: @32 kHz @44.1 kHz @48 kHz @96 kHz

4.6 Hz - 14.8 kHz 4.6 Hz - 19 kHz 4.6 Hz - 19 kHz 4.6 Hz - 44 kHz

+0/-0.1 dB: 0.7 Hz - 15.6 kHz 0.7 Hz - 20.5 kHz 0.7 Hz - 21.2 kHz 0.7 Hz - 44 kHz

+0/-3 dB: < -110 dB, 20 Hz to 20 kHz

Crosstalk: < -110 dB, 20 Hz to 20 kHz

D to A Conversion: 24 bit (Multi-bit delta sigma sampling at 4.1/5.6/6.1/6.1 MHz)

Selectable Sample Conversion Filters

In/Out Sample Rate 32/96 kHz: Fixed filter

In/Out Sample Rate 44.1/48 kHz: Filter choices: Linear, Natural, Vintage, Bright & Standard

Basic Package:

TC Icon, CPU 6000,
Mainframe incl DSP 6000,
No Dynamics software (optional)

Full Analog Package:

TC Icon, CPU 6000,
Mainframe incl DSP 6000,
3xADA24/96 cards,
No Dynamics software (optional)

Full Surround Package:

TC Icon, CPU 6000,
Mainframe incl DSP 6000,
3xADA24/96 cards and
MD5.1, MD3 & Toolbox5.1

TC Icons with CPU 6000,
Mainframes, ADA24/96 and
software licences (MD5.1,
MD3, VP8 and more) can
be ordered separately.

"FINALLY, a commercially-available A/D that beats all other high-end stand alone converters I have heard! You can quote me on that! System 6000's ADA 24/96."

Bob Katz, President, Digital Domain